



726 FREEDOM DR
CANTON, NORTH CAROLINA



INVESTMENT SUMMARY

GENERAL DESCRIPTION:

A high quality Morton® building comprised of two separate suites, 722 and 726 Freedom Drive.

Only 726 Freedom Drive is offered for sale. Current condition is mostly unfinished space with mixed-use potential. Each suite will be separately metered for utilities.

722 Freedom Drive is a Class A retail and manufacturing suite, home to Sabbath-Day Woods, specialists in handcrafted fine American furniture.

Located just one mile from I-40 Exit 33, the subject property is easily accessible and ideally situated to serve the Asheville metropolitan area. The site fronts I-40 with 250 feet of road frontage and billboard potential.

LOCATION:

726 Freedom Drive
Town of Canton, Haywood County, NC 28716
(Outside town limits)

PRICE:

\$249,000

PRICE / SQ.FT.:

\$74.80 per gross square foot including unheated areas

BUILDING AREA:

± 3,329 gross square feet unfinished

FLOORS:

One-story

LAND AREA:

1.0 acre by survey. 0.851 acres by tax card.
(Site area for both 722 & 726 Freedom Drive)

YEAR BUILT:

2003

CONSTRUCTION:

Morton® building. Wood frame; Hardiplank® & metal siding;
concrete flooring; metal roof

1 restroom

Ceiling height: ±12' to beams

1 sliding drive-in door (9' wide)



726 FREEDOM DRIVE

CANTON, NC

Gravel parking

ZONING:

None

UNDERGROUND UTILITIES:

Public water, public sewer, electricity, natural gas, fiber optics
3 Phase – 400 amp service available

LEGAL / TAX:

A portion of PIN: 8667-29-0239 Deed Book 519 at Page 762
2009 Real Estate Taxes: \$1,471.80 for both 722 and 726
Freedom Drive.

ROAD FRONTAGE:

± 250 feet per tax card with exposure to Interstate 40
Pole sign on site with interstate visibility

ACCESS:

Freedom Drive
± 0.9 miles from I-40 Exit 33
± 3 miles from Town of Canton and 18 miles to Asheville CBD

I-40 TRAFFIC COUNT:

44,000 vehicles per day east of I-40 Exit 33
NC DOT 2008 Study

SITE PHOTOGRAPHS



Building Front (NE)



Building Front (NW)



Interior



Interior



Interstate 40 Exposure

CLOSE-UP AERIAL



HIGH-UP AERIAL



FLOOR PLAN

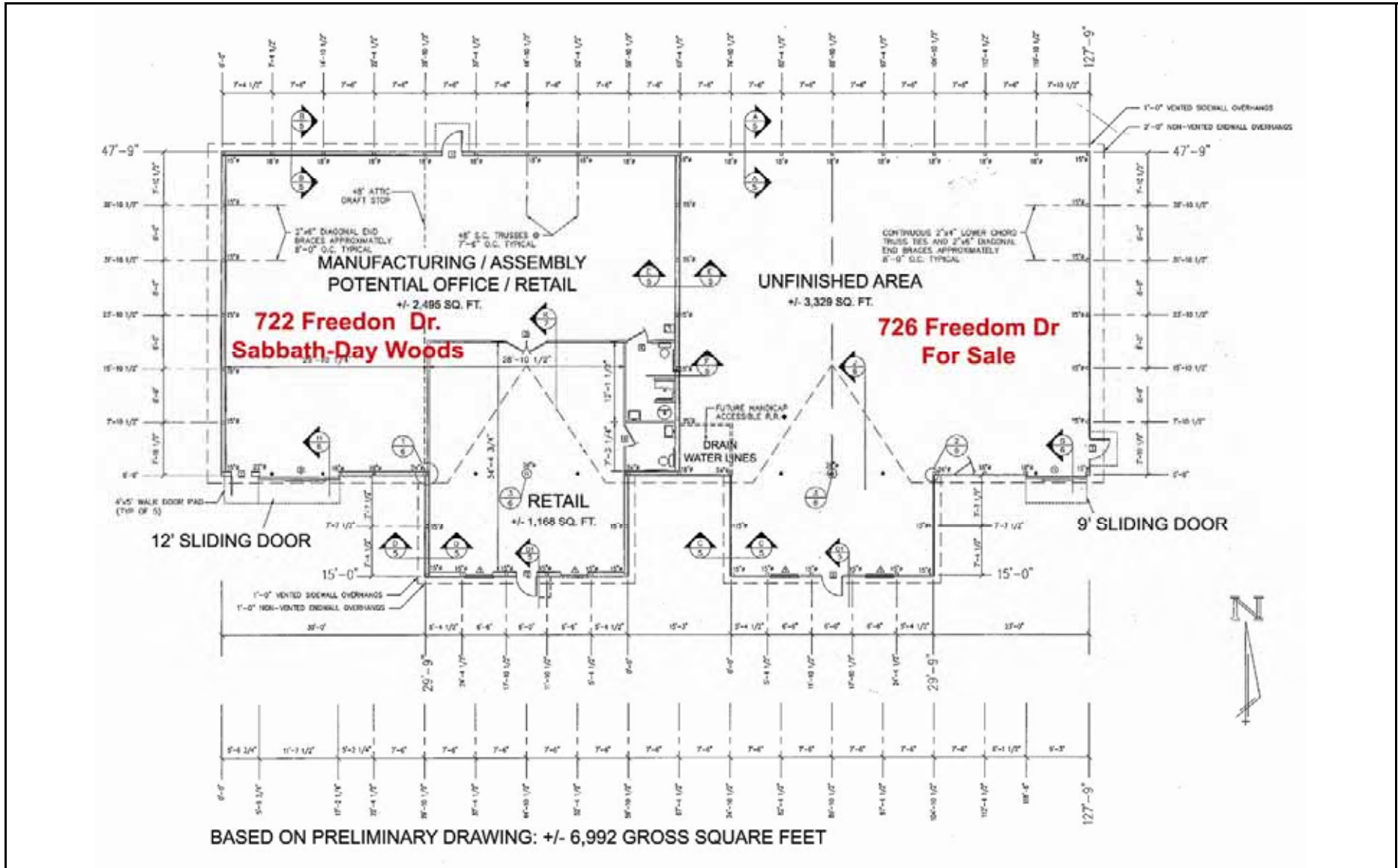



726 FREEDOM DRIVE

CANTON, NC

DISCLAIMER

This Marketing Memorandum (“Memorandum”) has been prepared by G/M Property Group, L.L.C. (“GMPG”) based on information that was furnished to us by sources we deem to be reliable. No warranty nor representation is made to the accuracy thereof; subject to correction of errors, omissions, change of price, prior sale, or withdrawal from market without notice.

This Memorandum is being delivered to prospective investors who may be interested in and capable of purchasing the Property. By its acceptance hereof, each recipient agrees that it will not copy, reproduce or distribute to others this Memorandum in whole or in part, at any time without the prior written consent of GMPG, and it will keep permanently confidential all information contained herein not already in public and will use this Memorandum only for the purpose of evaluating the possible purchase of the Property.

This Memorandum is being delivered by GMPG to prospective purchasers with the understanding that all prospective purchasers will conduct their own independent investigation of those matters which they deem appropriate in order to evaluate this offering.

GMPG reserves the right to request the return of any and all information enclosed.



G/M Property Group, LLC Commercial Real Estate Services
PO Box 18723 Asheville NC 28814
Tel 828.281.4024 Fax 828.281.4814
www.gmproperty.com